

GMC-158/159 Thin Profile Magnetic Catch

Features

- Ultra thin magnetic catch of 2.6 mm thick ideal for tight spaces
- Small body with strong magnetic force by using neodymium magnet
- Components to install to aluminium frame are available, contact Gripwell for assistance

Notes

- Max. temperature: 80°C
- GMC-158 is marked with "S"
- Recommended screw: countersunk screw M3 or countersunk wood screw 3.1

No.	Part Name	Material
①	Body	Steel (SPCC)
②	Magnet	Neodymium

Part No.	Finish	Magnetic Force	
GMC-158	Nickel	14.7 N	1.5 kg
GMC-159		39 N	4 kg
GMC-159-BL	Copper Plating, Black		

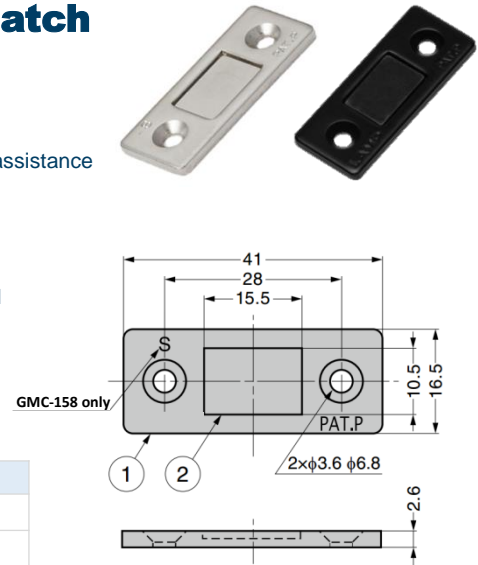

GMC-159-8 Strong Thin Profile Magnetic Catch

Features

- Ultra thin magnetic catch of 3 mm thick ideal for tight spaces
- Small body with extra strong magnetic force by using neodymium magnet

Notes

- Max. temperature: 80°C
- Recommended screw: countersunk screw M3 or countersunk wood screw 3.1

No.	Part Name	Material	Finish
①	Body	Steel	Nickel
②	Magnet	Neodymium	

Part No.	Magnetic Force
GMC-159-8	78.4 N 8 kg

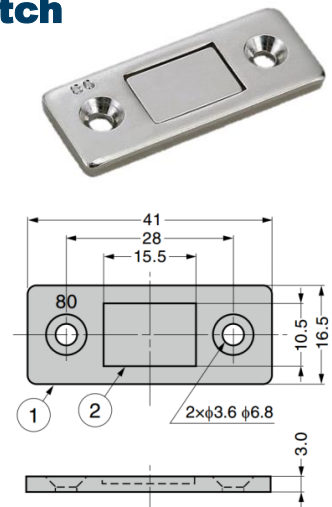

GMC-159-SUS Stainless Steel Thin Profile Magnetic Catch

Features

- Anti rust: made of stainless steel and acrylic resin coated magnet
- Ultra thin magnetic catch of 2.8 mm thick ideal for tight spaces
- Small body with strong magnetic force by using neodymium magnet

Notes

- Max. temperature: 80°C
- Recommended screw: countersunk screw M3 or countersunk wood screw 3.1

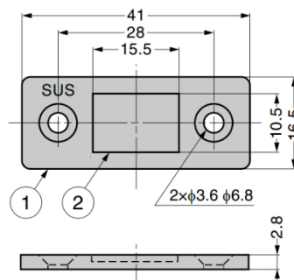

No.	Part Name	Material	Finish
①	Body	Stainless Steel (SUS430)	Barrel Polished
②	Magnet	Neodymium	Acrylic Coating

Part No.	Magnetic Force
GMC-159-SUS	49 N 5 kg